

PRIMARY SHAFT COMPONENTS DISASSEMBLY

B3E051517201M02

1. Disassemble in the order indicated in the table.

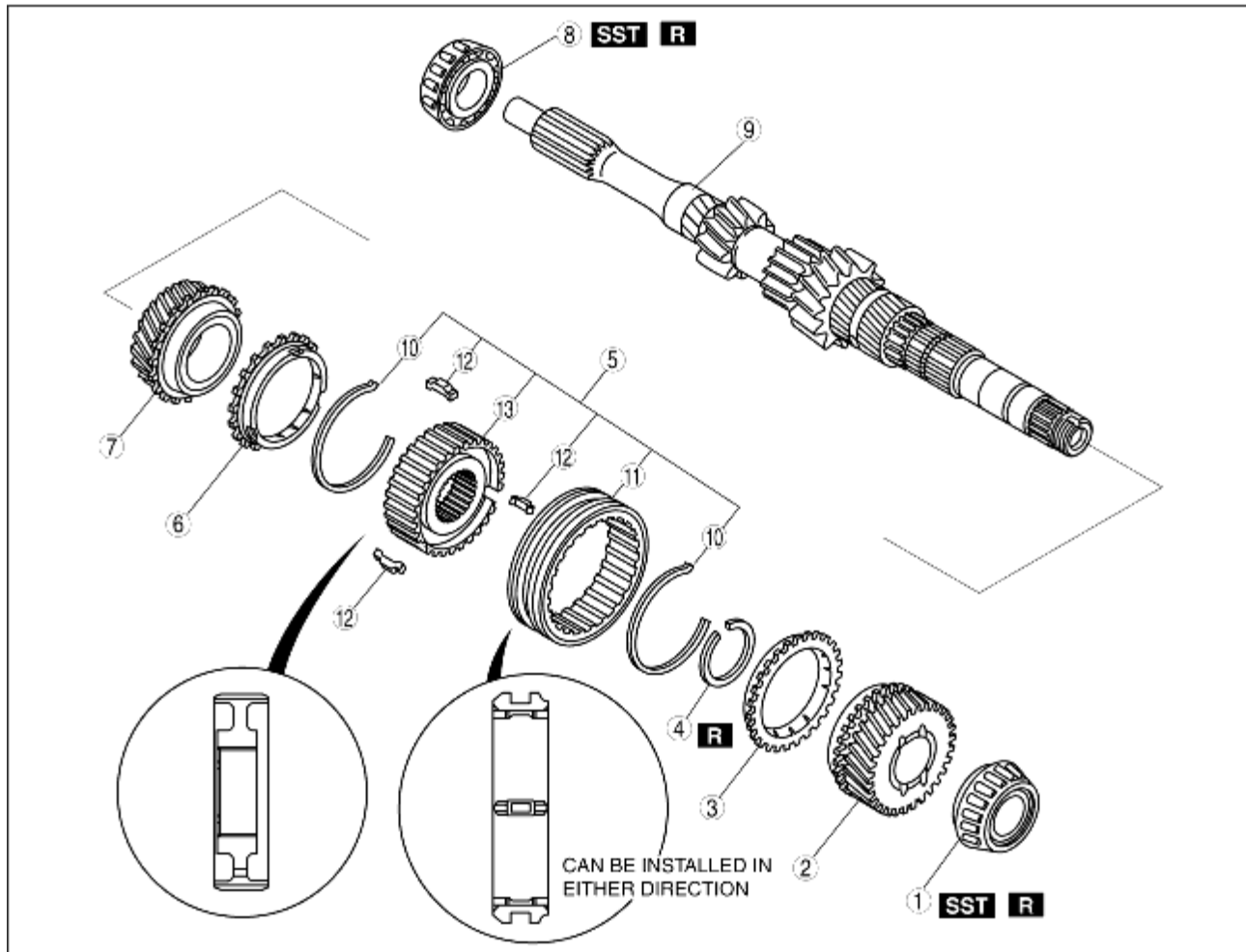

24 F5112M023

1	Bearing (4th gear end) (See Bearing (4th Gear End) Disassembly Note.)
2	4th gear
3	4th synchronizer ring
4	Retaining ring
5	3rd/4th clutch hub component (See 3rd/4th Clutch Hub Component, 3rd Synchronizer Ring and 3rd Gear Disassembly Note.)
6	3rd synchronizer ring (See 3rd/4th Clutch Hub Component, 3rd Synchronizer Ring and 3rd Gear Disassembly Note.)
7	3rd gear (See 3rd/4th Clutch Hub Component, 3rd Synchronizer Ring and 3rd Gear Disassembly Note.)
8	Bearing (primary shaft end) (See Bearing (Primary Shaft End) Disassembly Note.)
9	Primary shaft gear
10	Synchronizer key spring

11	3rd/4th clutch hub sleeve
12	Synchronizer key
13	3rd/4th clutch hub

Bearing (4th Gear End) Disassembly Note

1. Remove the bearing using the **SST**.

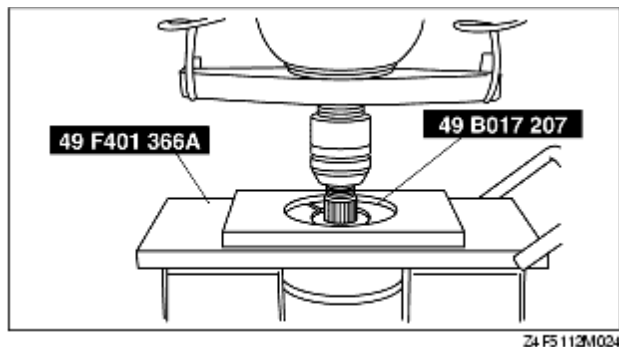

3rd/4th Clutch Hub Component, 3rd Synchronizer Ring and 3rd Gear Disassembly Note

1. Remove the retaining ring.
2. Remove the 3rd/4th clutch hub component, 3rd synchronizer ring, and 3rd gear using the **SST**.

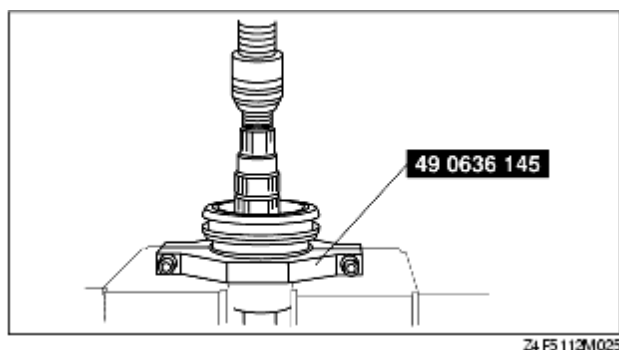

Bearing (Primary Shaft End) Disassembly Note

1. Remove the bearing using the **SST**.

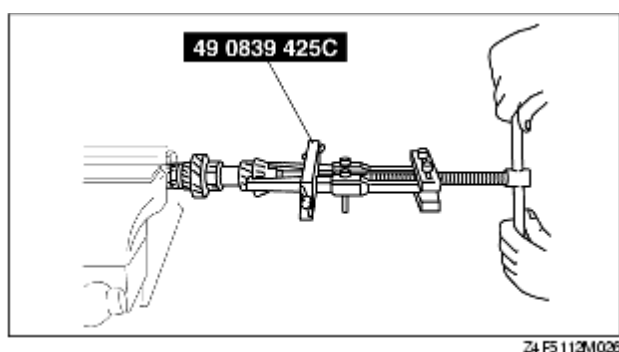

Caution

- Use protective plates in the vise to prevent damage to the primary shaft gear.